

Prepared under the direction of,  
Record and return to:  
Grady H. Williams, Jr., Esq.  
c/o Clay County Utility Authority  
3176 Old Jennings Road  
Middleburg, Florida 32068-3907

**GRANT OF EASEMENT**

(Corporation)

Parcel No.: 35-04-25-008223-001-00  
Project Name: Doctors Inlet Elementary School,  
Water Main Relocation for Parking Lot

THIS INDENTURE, made this 18th day of January, A.D. 2007, BETWEEN **THE SCHOOL BOARD OF CLAY COUNTY, FLORIDA**, a political subdivision of the State of Florida, hereinafter called **GRANTOR**, whose mailing address is 925 Center Street, Green Cove Springs, Florida 32043, and the **CLAY COUNTY UTILITY AUTHORITY**, hereinafter called **GRANTEE**, whose business address is 3176 Old Jennings Road, Middleburg, Florida 32068-3907.

WITNESSETH: That GRANTOR, for and in consideration of the sum of Ten Dollars (\$10.00) and other good and valuable consideration to them in hand paid by GRANTEE, the receipt whereof is hereby acknowledged, has granted, bargained, sold and conveyed to the GRANTEE, its successors and assigns forever an unobstructed right-of-way and easement with the right, privilege and authority to said GRANTEE, its successors and assigns, to construct, operate, lay, maintain, improve and/or repair associated equipment for water, wastewater, and/or reclaimed water utilities, any or all, on, along, over, through, across or under the following described land, situate in Clay County, Florida, to-wit:

See Exhibit "A" attached hereto and by reference made a part hereof.

TOGETHER, with the right of said GRANTEE, its successors and assigns, of ingress and egress, to and over said above described premises, and for doing anything necessary or useful or convenient or removing at any time any and all of said improvements upon, over, under or in said lands, together also with the right and easements, privileges and appurtenances in and to said land which may be required for the enjoyment of the rights herein granted. GRANTOR does hereby fully warrant the title to the Grant of Easement described herein, and will defend the same against the lawful claims of all persons whomsoever.

IN WITNESS WHEREOF, the said GRANTOR has caused this instrument to be executed in its name by its authorized officers and caused its Corporate Seal attested by its Secretary to be hereto affixed the day and year first above written.

Signed and Sealed in our Presence:

**THE SCHOOL BOARD OF CLAY COUNTY,  
FLORIDA**, a political subdivision of the State of Florida

Witness: \_\_\_\_\_  
Print Name: \_\_\_\_\_

By: \_\_\_\_\_  
Print Name: \_\_\_\_\_

Witness: \_\_\_\_\_  
Print Name: \_\_\_\_\_

Title: \_\_\_\_\_

STATE OF FLORIDA  
COUNTY OF CLAY

The foregoing instrument was acknowledged before me this \_\_\_\_\_, day of \_\_\_\_\_, 2007, by \_\_\_\_\_, as \_\_\_\_\_, of **THE SCHOOL BOARD OF CLAY COUNTY, FLORIDA**, a political subdivision of the State of Florida, who is personally known to me or has produced \_\_\_\_\_ as identification.

\_\_\_\_\_  
Print Name: \_\_\_\_\_  
Notary Public in and for the  
County and State Aforesaid  
My Commission Expires:

Accepted on behalf of the Clay County Utility Authority.

By: \_\_\_\_\_  
Ray O. Avery, Executive Director

Doctors Inlet Elementary School,  
Water Main Relocation for Parking Lot

**EXHIBIT "A"**

An easement for utilities covering a portion of Block 3, Leetonia, Clay County, Florida, according to plat thereof recorded in Plat Book 2, page 65 of the public records of said county, said portion being more particularly described as follows:

Commence at the intersection of the centerline of Center Street with the north line of County Road No. 220; thence on said north line, South 88 degrees 58 minutes 47 seconds West, 75.98 feet to the point of beginning; thence continue South 88 degrees 58 minutes 47 seconds West, 15.00 feet; thence North 00 degrees 58 minutes 16 seconds West, 93.98 feet; thence North 68 degrees 39 minutes 09 seconds West, 33.19 feet; thence South 89 degrees 22 minutes 50 seconds West, 140.09 feet; thence North 00 degrees 18 minutes 04 seconds West, 40.73 feet; thence North 89 degrees 41 minutes 56 seconds East, 15.00 feet; thence South 00 degrees 18 minutes 04 seconds East, 25.64 feet; thence North 89 degrees 22 minutes 50 seconds East, 127.92 feet; thence South 68 degrees 39 minutes 09 seconds East, 46.16 feet; thence South 00 degrees 58 minutes 16 seconds East, 104.02 feet to the point of beginning.

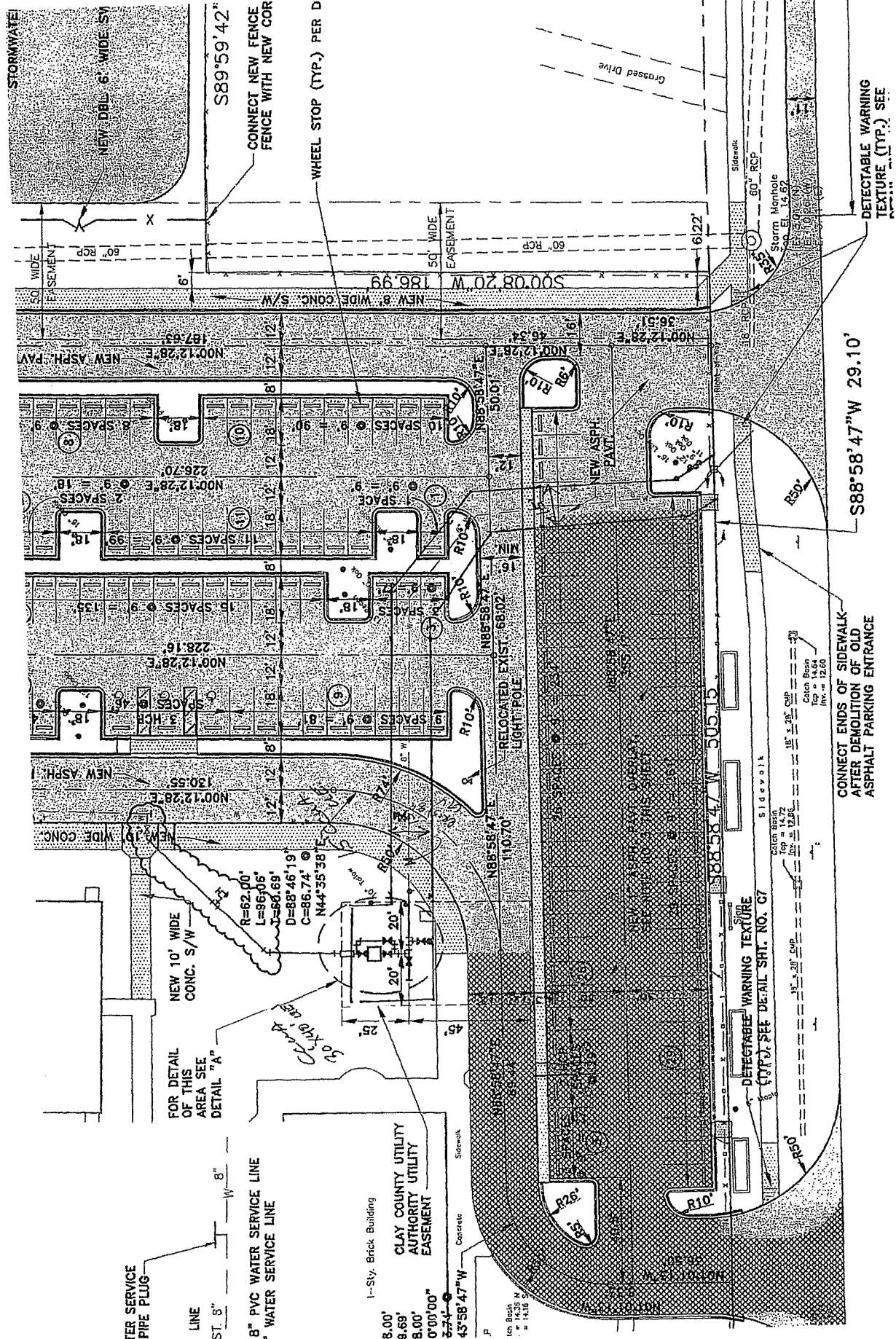

ATER SERVICE  
PIPE PLUG

E LINE  
1ST 8"

8" PVC WATER SERVICE LINE  
1" WATER SERVICE LINE

1-Story Brick Building  
CLAY COUNTY UTILITY  
AUTHORITY UTILITY  
EASEMENT  
Concrete  
45°58'47"W

8.00'  
9.69'  
8.00'  
0'00'00"  
3.74'

FOR DETAIL  
OF THIS  
AREA SEE  
DETAIL "A"

NEW 10' WIDE  
CONC. S/W

R=62.00'  
L=96.06'  
C=86.69'  
D=88'46'19"  
N44°35'38"E

50' R10' det.

Sidewalk

Concrete

Storm Drain

NEW ASPH. PAVT.

NEW ASPH. PAVT.

DETECTABLE WARNING TEXTURE  
(TYP.) SEE DETAIL SHT. NO. 07

Storm Manhole  
60" RCP  
Elev. 12.67  
12.67

CONNECT ENDS OF SIDEWALK  
AFTER DEMOLITION OF OLD  
ASPHALT PARKING ENTRANCE

S88°58'47"W 29.10'

DETECTABLE WARNING  
TEXTURE (TYP.) SEE

2 2 0

N O.

(00' Right-of-Way)